



San Diego County Sanitation District Harmony Grove Sewer Service Area Sewer Charges – Rate Study FINAL REPORT

Fiscal Year 2015-16

27368 Via Industria, Suite 110
Temecula, California 92590
T. 951.587.3500 800.755.6864
F. 951.587.3510 888.326.6864

www.willdan.com/financial



TABLE OF CONTENTS

INTRODUCTION 1

PART I – INTRODUCTION AND SYSTEM DESCRIPTION 4

PART II – COST ESTIMATE 6

PART III – METHOD OF APPORTIONMENT 7

INTRODUCTION

Willdan Financial Services (“Willdan”) was retained by the San Diego County Sanitation District (“District”) to prepare a Sewer Charge Rate Study (“The Report”) for the Harmony Grove Sewer Service Area (“Service Area”).

The results of the Report presented herein are based on a financial plan which was designed to provide revenues sufficient to fund the ongoing operating and capital costs necessary to operate and maintain the Harmony Grove Sewer Facilities, while meeting the financial requirements and goals set forth by the District.

The purpose of the Sewer Charge is to fund the operations and maintenance costs (including capital replacement reserves) of certain wastewater collection, conveyance, and treatment improvements, and other appurtenant facilities (hereinafter referred to as “Facilities”) that will serve certain properties located in the Harmony Grove Village area.

In meeting the overall objectives of the District, the wastewater rate design must also conform to the State Constitution. More specifically, Proposition 218 requires that property related fees and charges, such as wastewater rates (as affirmed in *Bighorn-Desert View Water Agency v. Verjil*) not exceed the reasonable cost of providing the service associated with the fee or charge, and that they also not exceed the proportional cost of the service attributable to the parcel that is subject to the fee or charge. Stated another way, this means that no customer or parcel should pay any more or less than its proportional share of the costs of operating the utility and providing service. The wastewater rates developed in this report are intended to comply with the requirements for wastewater fees as outlined in the California Health & Safety Code (§5470 et seq.), Proposition 218 (Articles XIII C and XIII D of the California Constitution), and the “Proposition 218 Omnibus Implementation Act” (California Government Code §53750 et seq.).

For compliance with State and Proposition 218 guidelines, a wastewater utility is required to utilize a cost allocation approach that fairly allocates costs among customer classes. This is accomplished by allocating costs based proportionately on the estimated annual discharge. Equivalent Dwelling Units (EDUs) are used to measure the relative demand for wastewater services for different types of customers.

This Report, submitted for consideration by the Board of Directors of the San Diego County Sanitation District, consists of the following three (3) parts:

PART I Improvements

This part contains a description of the proposed improvements to be operated and maintained from the proceeds of the Sewer Charge.

PART II Cost Estimate

This part contains an estimate of the annual operations and maintenance costs proposed to be financed by the Sewer Charge.

PART III Method of Apportionment

This part describes the manner in which costs were assigned sewer service units, hereinafter referred to as Equivalent Dwelling Units (“EDUs”) within the Service Area.

Recommendations

In order to ensure that the Sewer Charges applied to the Harmony Grove development provide adequate revenue to fund the operations and maintenance (including capital replacement reserves) of the Sewer Facilities, it is recommended that all EDUs receiving benefit from the sewer facilities be charged either a “Standby Fee”, or “Service Charge”. Standby Fees should be applied to lots that do not yet have structures generating wastewater flows – yet the infrastructure necessary to receive those flows is readily available, while Service Charges should be applied to lots once the structural improvements begin discharging wastewater. Stated another way, Sewer Charges would consist of either a Standby Fee, or Service Charge being applied to each lot within the service area based on its development status.

To ensure appropriate cost recovery and adequate expense coverage throughout project development, we make the following recommendations for your consideration:

- It is recommended that the District establish procedures to deal with the anticipated transition of EDUs from Standby-status to Service-status so as to appropriately recover costs from EDUs in Harmony Grove.
- It is recommended that the District periodically review the timing of revenues and expenses in this Study with respect to the procedural and administrative timing of placing the Sewer Standby Fees and Service Charges, as presented in the Engineer’s Report, on the annual Property Tax Roll. In the event that expenses are incurred in any Fiscal Year (“FY”) for which a Standby Fee cannot be levied in time to provide funding of

these expenses then an alternative means of meeting these expenses must be considered as a temporary measure until such time as revenue from the Standby Fee can be realized.

PART I – INTRODUCTION AND SYSTEM DESCRIPTION

Introduction

The Study utilizes generally accepted rate-making principles resulting in the development of Sewer Service Charges which are projected to: (1) generate sufficient revenue to meet the financial requirements of the utility, (2) address the need to recover costs from users in a manner which is fair and equitable relative to the service being provided, and (3) meet the financial and management goals of the District with respect to Harmony Grove.

General System Description – Harmony Grove

When the Harmony Grove Village development project was approved, a Sewer Maintenance District was established to operate and maintain the sanitation facilities which were to be constructed at a future time to specifically serve the project. The County has since incorporated the Harmony Grove Sewer Maintenance District into the San Diego County Sanitation District. Harmony Grove Village will be designated the Harmony Grove Service Area of the San Diego County Sanitation District, and it will have charges that are separate and unique from the rest of the District since the collection, conveyance and treatment facilities being constructed will serve only Harmony Grove Village.

The Facilities will serve the residential and commercial properties within the Harmony Grove Village development. The Facilities will occupy a total of approximately 470 acres, and is bounded to the north by Mt. Whitney Road, to the south and east by Harmony Grove Road, and to the west by undeveloped land (location map included as Attachment A). At build-out, the developed area served by the Facilities is anticipated to encompass 737 residential units, and approximately 20,000 square feet of commercial space.

1) The sanitation Facilities include a gravity sewer collection system, pump station, force main, treatment facility, and wet weather storage. The Plans and Specifications for the Improvements of the Facilities are included by reference and consist of the following documents on file with the County: Wastewater Treatment/Water Reclamation Plant & Wet Weather Storage

- Plans for the Construction of Harmony Grove Water Reclamation Plant, County of San Diego, California, December 13, 2012 [Plan No. PDS2012-LDMJIP-0050]

2) Pump Station

- Plans for the Construction of Harmony Grove Sewer Lift Station, County of San Diego, California, November 19, 2012 [Plan No. PDS2012-LDMJIP-0051]

3) Gravity Sewer Collection System & Forcemain

- Tentative Map 5365 Improvement Plans (Phase 1) - PDS2011-2140-5365-1, 2, 3, 4, 5, 6, 7.
- Tentative Map 5365 Improvement Plans (Phase 2) - PDS2013--LDMJIP-0007 [TM 5365-8, 9, 10, 11].

PART II – COST ESTIMATE

In order to develop the Sewer Service Charge presented herein, an estimate of maximum annual projected costs for the Harmony Grove service area for a test year was developed by the District and provided to Willdan for purposes of this Study and hereinafter referred to as Test Year costs. Table 1 below presents the detailed Test Year costs assumed for Harmony Grove¹.

Table 1
Harmony Grove
 Estimated Annual Costs

	<u>Test Year</u>
<u>Pump Station</u>	
Labor-Op	\$ 26,617
Variable-Op	39,447
Regular O&M	4,743
<u>Water Reclamation Plant</u>	
Labor-Op	\$ 239,556
Variable-Op	231,228
Regular O&M	11,907
<u>Collection</u>	19,208
<u>Administrative</u>	13,125
<hr/>	
Total Operating Costs	\$ 585,831
Total Annual Capital Replacement Costs	62,926
Total Annual Costs	\$ 648,757

¹ It is assumed that costs provided by the District were provided on a Fiscal Year basis.

PART III – METHOD OF APPORTIONMENT

The development of Sewer Service Charges for utility service is subject to the requirements set forth in Proposition 218 which requires that sewer rates be developed such that each service unit, EDU, is charged in a manner proportionate to the costs to provide that unit of sewer service.

Projection of Costs

The analysis presented herein is substantively based upon the District's projection of the maximum annual costs to provide sewer service for the next 5 years to only the Harmony Grove sewer service area and the costs associated with it are associated with only the EDUs within Harmony Grove. A detailed presentation of those costs is presented in Table 1 on the previous page.

Projection of Equivalent Dwelling Units (EDUs)

For this analysis, the majority of EDUs are projected to be of the Single Family Residential class of customer. All non-residential land use parcels, including commercial, fire station, public and private parks, recreation, and institutional lots, have been assigned EDUs based on the expected discharge flow from the currently planned facilities relative to the discharge flow of a single family home. Exhibit 1 below shows the expected discharge flows for non-residential land uses based on the 2007 Master Reclamation Plan for Harmony Grove, and their corresponding EDU assignments as provided by the District. Parcels that are not expected to discharge wastewater or otherwise connect to the sewer system have been assigned 0 EDUs.

Exhibit 1 – Harmony Grove, Estimated Wastewater Generation and EDUs

APN	Land Use	Dwelling Units	Acres	Generation Rate (gpd)/Acre	Flow (gpd)	EDUs
Various	Residential	710		240		710.00
Various	Work/Live Units	27		1.2 EDU ea.		32.40
235-562-02	Fire Station		2.54	1500	3810	15.88
235-570-56	Commercial #1		1.3	2500	3250	13.54
235-571-17	Commercial #2		1.6	2500	4000	16.67
235-571-20	Public Park#1		2.51	500	1255	5.23
235-572-05	Public Park#2		3.58	500	1790	7.46
235-572-07	Equestrian Park		3.65	500	1825	7.60
235-623-19,23	Phase II Private Park		4.35	500	2175	9.06
235-601-10	Phase I Rec Cnt Private Park		1.37	500	685	2.85
235-572-01	Sewer Pump Station					0.00
235-562-01	Sewer Treatment Pl.					0.00
235-562-03	Institutional		1.85	1500	2775	11.56
TOTAL						832.25
1. Reference Final Map Nos. 15888 through 15894, and 15995						
2. 1 EDU=240 gpd						

One previously developed residential parcel that lies within the boundaries of the Service Area is currently on septic, with no anticipation of it connecting to this sewer system. Since it will not be connecting to the system, and therefore not receiving any benefit from it, it has been assigned 0 EDUs.

Properties within the boundaries of the district receive EDU assignments, and are subject to the sewer standby charges, on the basis of the benefit they receive from their ability to connect to, and discharge sewer to, the sanitary sewer system and facilities being constructed to serve the Harmony Grove project. There are parcels in the district whose eventual end use may provide a benefit to the general public, such as the park parcels, and the fire station parcel. However, any general benefits to the public associated with these uses are not being funded in any way by this sewer standby charge. Otherwise stated, the standby charge is used to fund only the sewer-related (special) benefit of having readily available sewer infrastructure capable of receiving wastewater. Any non-sewer-related (general) benefit that may be associated with public parks or a public fire station is separate, distinct, and in no way related to the sewer-related (special benefit) standby charge.

The District will annually review the status of constructed improvements within the Harmony Grove Service Area. Once more detail is known about the strength and flow characteristics of constructed non-residential improvements, the number of EDUs assigned to the improvement may be modified to more accurately reflect impacts to the on-site treatment facilities. The current projection of Sewer Service EDUs is presented in Table 2 below.

Allocation of Sewer Service Costs to Sewer Service EDUs

In order to develop the allocation of Harmony Grove sewer costs to the Sewer Service Charge, a projection of the maximum EDUs subject to the Charge was provided by the District. This projection indicated the maximum Service EDUs projected in the test year. The allocation of maximum Total Annual Costs, which are to be recovered through the Sewer Charges, employed the following methodology. The Total Annual Costs were allocated to the Sewer Service Charges based on the maximum number of projected Service EDUs to Total EDUs in Harmony Grove. The allocation of costs to Service EDUs, and the projected maximum Service Charge per EDU, is detailed in Table 2 below.

Table 2	
Harmony Grove	
Allocation of Costs per EDU	
	<u>Test Year</u>
Total Annual Costs	\$648,757
Total EDUs	832.25
Maximum Annual Service Charge per EDU	\$ 780

It is anticipated that implementation of the Sewer Service Charge will occur in FY 2016. Further, the District has indicated that expenses/reserve contributions for FY 2016 through FY 2020 are not projected to exceed the Total Annual Costs presented in Tables 1 and 2.

In summary, the maximum Sewer Service Charge per EDU for FY 2016 through FY 2020 is projected to be \$780.

The annual Sewer Service Charge assigned to each service EDU in the Service Area has been calculated based on the EDUs and calculated Sewer Service Charge, as shown in the following equation:

$$\text{Annual Sewer Service Charge} = \text{Total service EDUs} \times \text{Sewer Service Charge Annual Rate}$$

ATTACHMENT A
SEWER SERVICE DISTRICT BOUNDARIES

PROPOSED BOUNDARIES OF HARMONY GROVE SEWER SERVICE AREA

COUNTY OF SAN DIEGO
STATE OF CALIFORNIA

VICINITY MAP

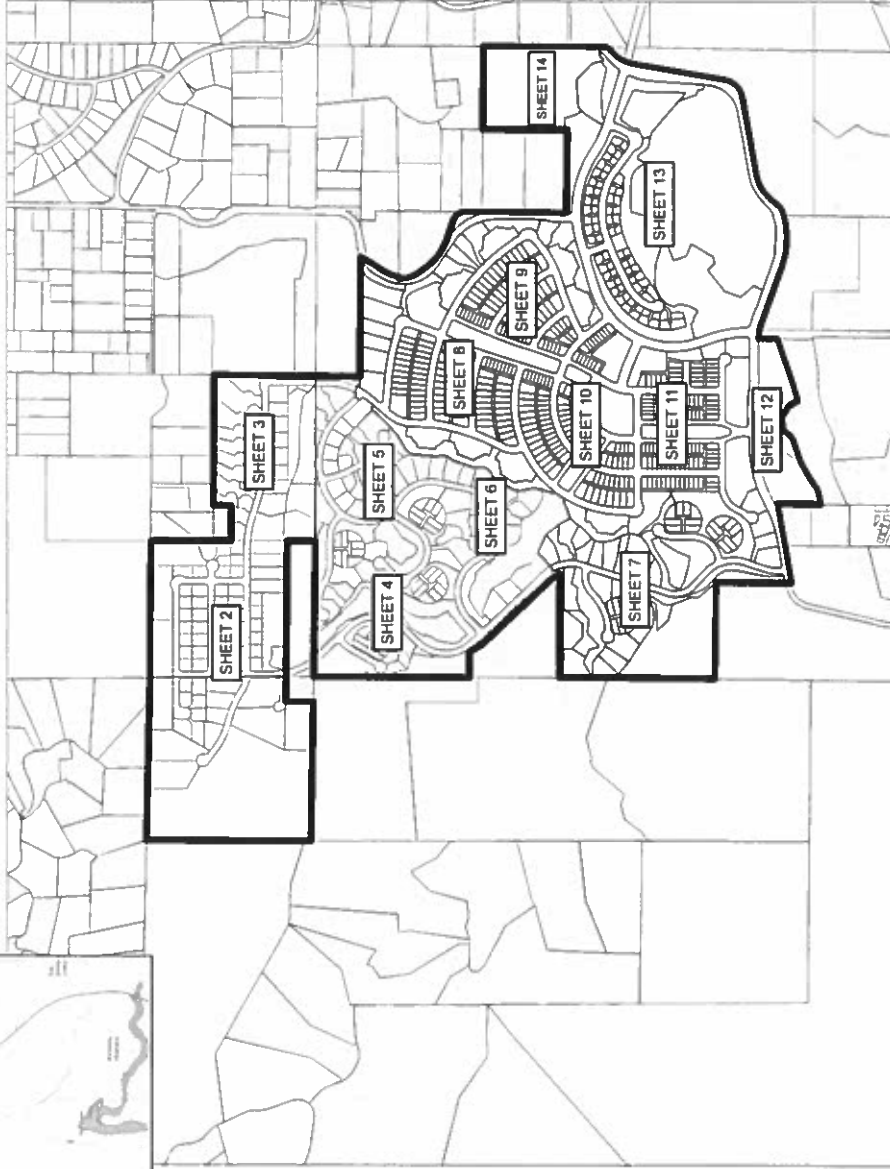
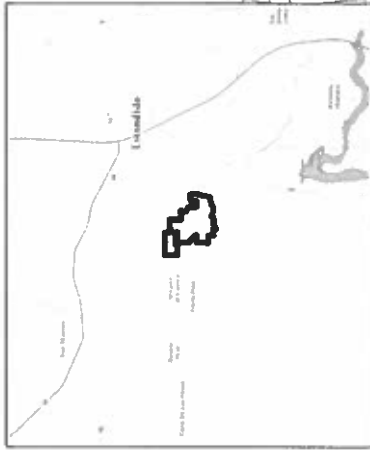

FILED IN THE OFFICE OF THE CLERK OF THE BOARD OF SUPERVISORS OF THE COUNTY OF SAN DIEGO THIS DAY OF _____, 20____.

CLERK OF THE BOARD OF SUPERVISORS
COUNTY OF SAN DIEGO

I HEREBY CERTIFY THAT THE WITHIN MAP SHOWING THE PROPOSED BOUNDARIES OF HARMONY GROVE SEWER SERVICE AREA, COUNTY OF SAN DIEGO, STATE OF CALIFORNIA, WAS APPROVED BY THE BOARD OF SUPERVISORS OF THE COUNTY OF SAN DIEGO AT A REGULAR MEETING THEREOF, HELD ON THE _____ DAY OF _____, 20____, BY ITS RESOLUTION NO. _____.

CLERK OF THE BOARD OF SUPERVISORS
COUNTY OF SAN DIEGO

FILED THIS _____ DAY OF _____, 20____ AT _____ O'CLOCK _____ IN BOOK _____ PAGE _____ OF MAPS OF ASSESSMENT AND COMMUNITY FACILITIES DISTRICTS AND AS INSTRUMENT NO. _____ IN THE OFFICE OF THE COUNTY RECORDER IN THE COUNTY OF SAN DIEGO, STATE OF CALIFORNIA.

BY DEPUTY
COUNTY RECORDER
COUNTY OF SAN DIEGO
STATE OF CALIFORNIA

FOR A DETAILED DESCRIPTION OF THE LINES AND DIMENSIONS OF LOTS OR PARCELS SHOWN ON THIS MAP, REFER TO THE COUNTY OF SAN DIEGO ASSESSOR'S MAPS WHICH SHALL GOVERN WITH RESPECT TO ALL DETAILS CONCERNING THE LINES AND DIMENSIONS OF SUCH LOTS OR PARCELS.

Legend
Proposed Boundary



PROPOSED BOUNDARIES OF HARMONY GROVE SEWER SERVICE AREA

COUNTY OF SAN DIEGO
STATE OF CALIFORNIA



Legend

- 1 Map Reference Number
- Proposed District Boundary



PROPOSED BOUNDARIES OF HARMONY GROVE SEWER SERVICE AREA

COUNTY OF SAN DIEGO
STATE OF CALIFORNIA

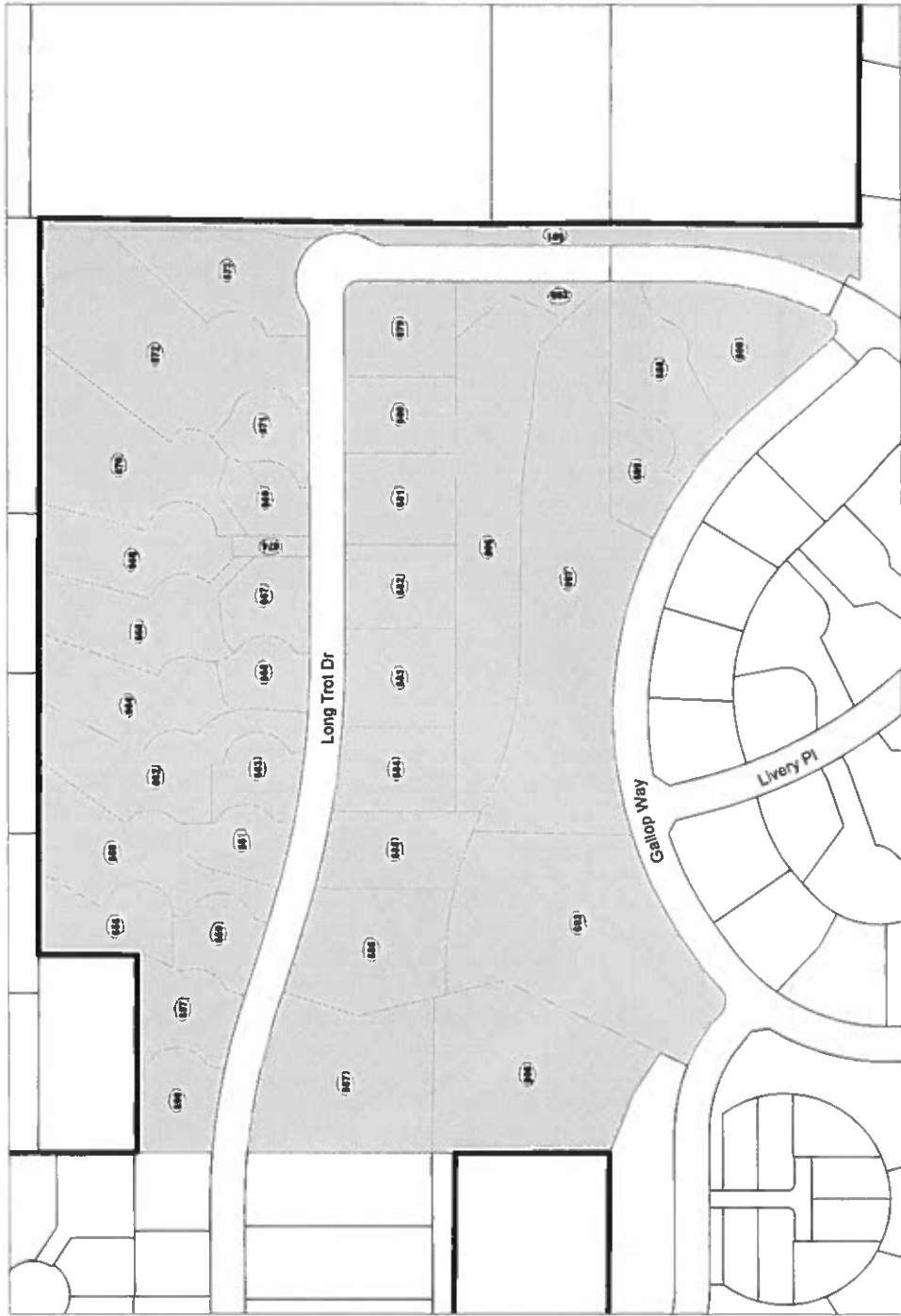

Legend

- Map Reference Number
- Proposed District Boundary



PROPOSED BOUNDARIES OF HARMONY GROVE SEWER SERVICE AREA

COUNTY OF SAN DIEGO
STATE OF CALIFORNIA



Legend

- 1 Map Reference Number
- Proposed District Boundary



PROPOSED BOUNDARIES OF HARMONY GROVE SEWER SERVICE AREA

COUNTY OF SAN DIEGO
STATE OF CALIFORNIA



Legend

- Map Reference Number
- Proposed District Boundary



PROPOSED BOUNDARIES OF HARMONY GROVE SEWER SERVICE AREA

COUNTY OF SAN DIEGO
STATE OF CALIFORNIA



Legend

- Map Reference Number
- ▭ Proposed District Boundary



PROPOSED BOUNDARIES OF HARMONY GROVE SEWER SERVICE AREA

COUNTY OF SAN DIEGO
STATE OF CALIFORNIA

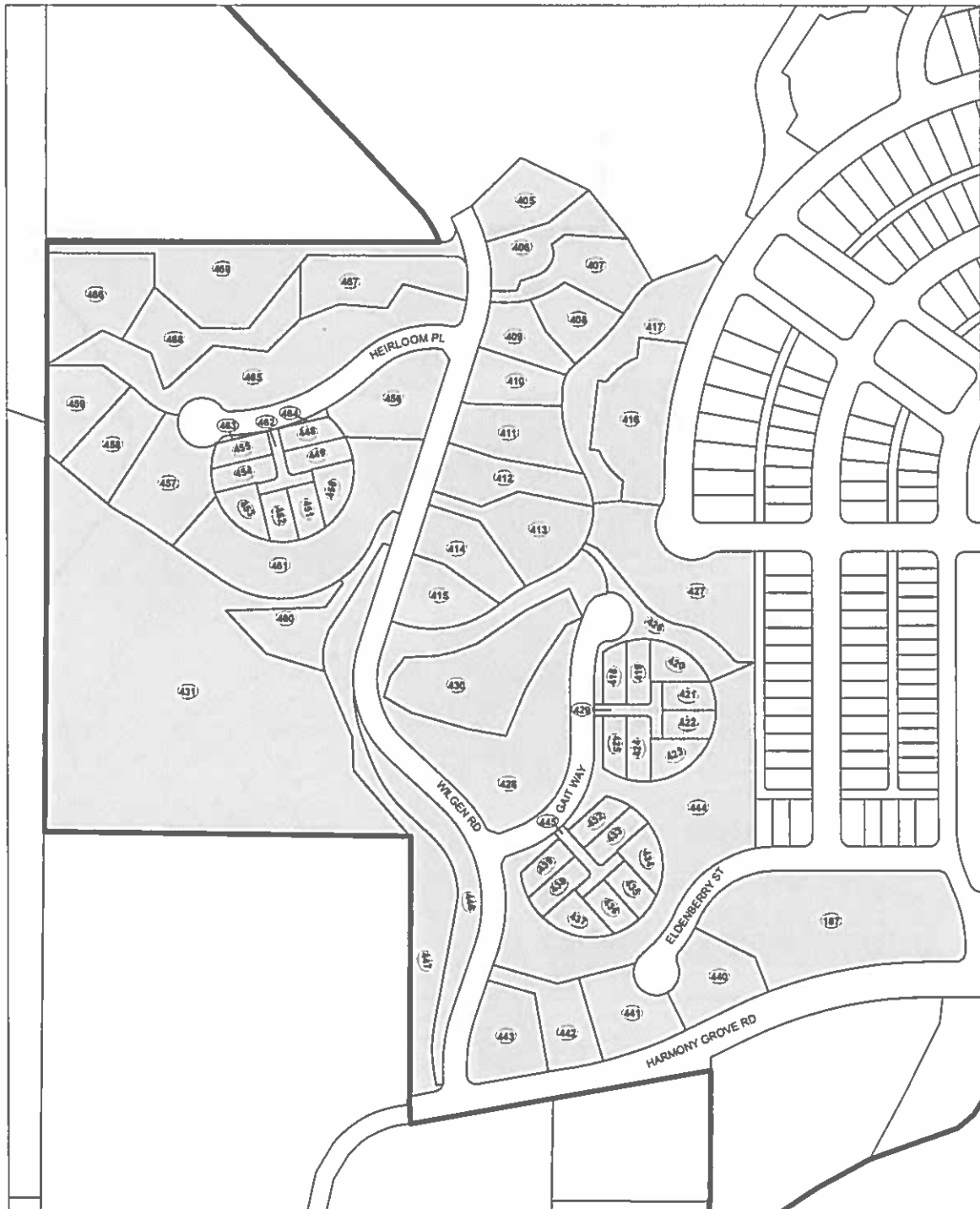

Legend

-  Map Reference Number
-  Proposed District Boundary



PROPOSED BOUNDARIES OF HARMONY GROVE SEWER SERVICE AREA

COUNTY OF SAN DIEGO
STATE OF CALIFORNIA



Legend

- Map Reference Number
- Proposed District Boundary



PROPOSED BOUNDARIES OF HARMONY GROVE SEWER SERVICE AREA

COUNTY OF SAN DIEGO
STATE OF CALIFORNIA



Legend

- Map Reference Number
- Proposed District Boundary



PROPOSED BOUNDARIES OF HARMONY GROVE SEWER SERVICE AREA

COUNTY OF SAN DIEGO
STATE OF CALIFORNIA



Legend

- Map Reference Number
- Proposed District Boundary



PROPOSED BOUNDARIES OF HARMONY GROVE SEWER SERVICE AREA

COUNTY OF SAN DIEGO
STATE OF CALIFORNIA

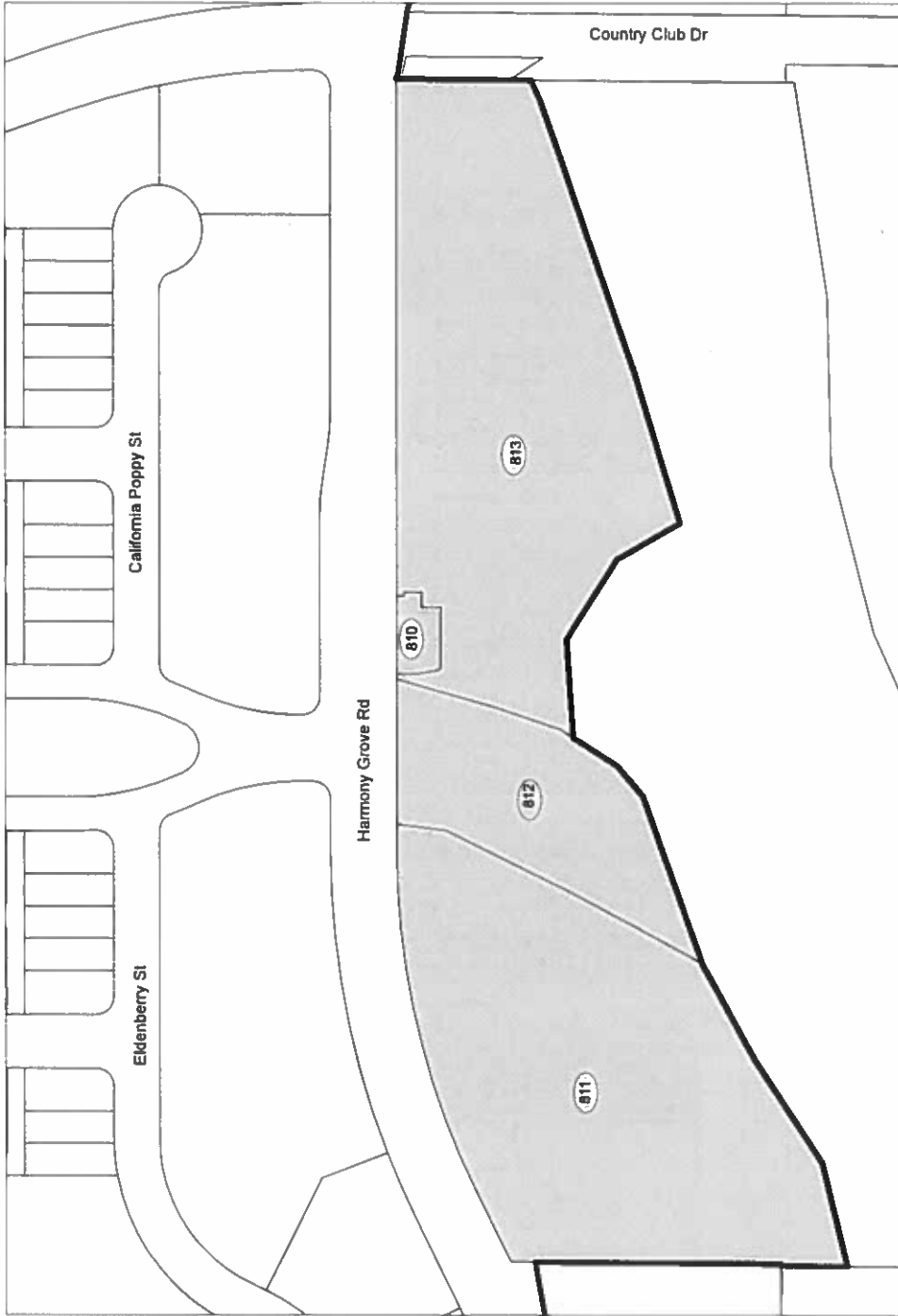

PROPOSED BOUNDARIES OF HARMONY GROVE SEWER SERVICE AREA

COUNTY OF SAN DIEGO
STATE OF CALIFORNIA

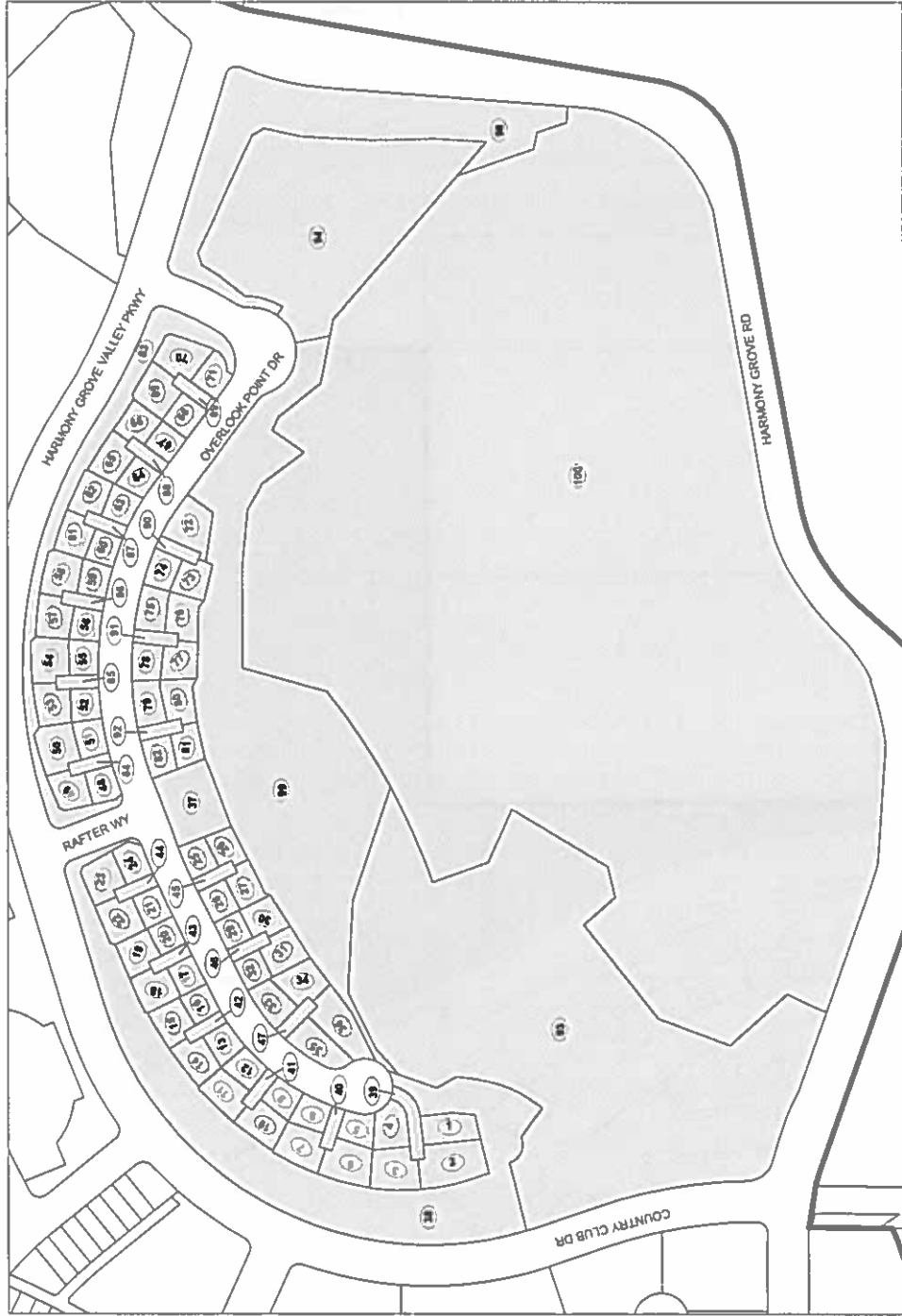

Legend
Map Reference Number
Proposed District Boundary





PROPOSED BOUNDARIES OF HARMONY GROVE SEWER SERVICE AREA

COUNTY OF SAN DIEGO
STATE OF CALIFORNIA



Legend

-  Map Reference Number
-  Proposed District Boundary



PROPOSED BOUNDARIES OF HARMONY GROVE SEWER SERVICE AREA

COUNTY OF SAN DIEGO
STATE OF CALIFORNIA

ASSESSORS PARCEL NUMBER	MAP REFERENCE NUMBER	SHEET NUMBER	ASSESSORS PARCEL NUMBER	MAP REFERENCE NUMBER	SHEET NUMBER	ASSESSORS PARCEL NUMBER	MAP REFERENCE NUMBER	SHEET NUMBER	ASSESSORS PARCEL NUMBER	MAP REFERENCE NUMBER	SHEET NUMBER	ASSESSORS PARCEL NUMBER	MAP REFERENCE NUMBER	SHEET NUMBER	ASSESSORS PARCEL NUMBER	MAP REFERENCE NUMBER	SHEET NUMBER
235-560-01	1	13	235-561-14	61	13	235-570-20	124	11	235-571-19	184	10	235-581-17	244	10	235-590-01	304	8
235-560-02	2	13	235-561-15	62	13	235-570-21	125	11	235-571-20	185	10	235-581-18	245	10	235-590-02	305	8
235-560-03	3	13	235-561-16	63	13	235-570-22	126	11	235-571-21	186	10	235-581-19	246	10	235-590-03	306	8
235-560-04	4	13	235-561-17	64	13	235-570-23	127	11	235-571-22	187	10	235-581-20	247	10	235-590-04	307	8
235-560-05	5	13	235-561-18	65	13	235-570-24	128	11	235-571-23	188	10	235-581-21	248	10	235-590-05	308	8
235-560-06	6	13	235-561-19	66	13	235-570-25	129	11	235-571-24	189	10	235-581-22	249	10	235-590-06	309	8
235-560-07	7	13	235-561-20	67	13	235-570-26	130	11	235-571-25	190	10	235-581-23	250	11	235-590-07	310	8
235-560-08	8	13	235-561-21	68	13	235-570-27	131	11	235-571-26	191	10	235-581-24	251	11	235-590-08	311	8
235-560-09	9	13	235-561-22	69	13	235-570-28	132	11	235-571-27	192	10	235-581-25	252	11	235-590-09	312	8
235-560-10	10	13	235-561-23	70	13	235-570-29	133	11	235-571-28	193	10	235-581-26	253	11	235-590-10	313	8
235-560-11	11	13	235-561-24	71	13	235-570-30	134	11	235-571-29	194	10	235-581-27	254	11	235-590-11	314	8
235-560-12	12	13	235-561-25	72	13	235-570-31	135	11	235-571-30	195	10	235-581-28	255	11	235-590-12	315	8
235-560-13	13	13	235-561-26	73	13	235-570-32	136	11	235-571-31	196	10	235-581-29	256	11	235-590-13	316	8
235-560-14	14	13	235-561-27	74	13	235-570-33	137	11	235-571-32	197	10	235-581-30	257	11	235-590-14	317	8
235-560-15	15	13	235-561-28	75	13	235-570-34	138	11	235-571-33	198	10	235-581-31	258	11	235-590-15	318	8
235-560-16	16	13	235-561-29	76	13	235-570-35	139	11	235-571-34	199	10	235-581-32	259	11	235-590-16	319	8
235-560-17	17	13	235-561-30	77	13	235-570-36	140	11	235-571-35	200	10	235-581-33	260	11	235-590-17	320	8
235-560-18	18	13	235-561-31	78	13	235-570-37	141	11	235-571-36	201	10	235-581-34	261	11	235-590-18	321	8
235-560-19	19	13	235-561-32	79	13	235-570-38	142	11	235-571-37	202	10	235-581-35	262	11	235-590-19	322	8
235-560-20	20	13	235-561-33	80	13	235-570-39	143	11	235-571-38	203	10	235-581-36	263	11	235-590-20	323	8
235-560-21	21	13	235-561-34	81	13	235-570-40	144	11	235-571-39	204	10	235-581-37	264	11	235-590-21	324	8
235-560-22	22	13	235-561-35	82	13	235-570-41	145	11	235-571-40	205	10	235-581-38	265	11	235-590-22	325	8
235-560-23	23	13	235-561-36	83	13	235-570-42	146	11	235-571-41	206	10	235-581-39	266	11	235-590-23	326	8
235-560-24	24	13	235-561-37	84	13	235-570-43	147	11	235-571-42	207	10	235-581-40	267	11	235-590-24	327	8
235-560-25	25	13	235-561-38	85	13	235-570-44	148	11	235-571-43	208	10	235-581-41	268	11	235-590-25	328	8
235-560-26	26	13	235-561-39	86	13	235-570-45	149	11	235-571-44	209	10	235-581-42	269	11	235-590-26	329	8
235-560-27	27	13	235-561-40	87	13	235-570-46	150	11	235-571-45	210	10	235-581-43	270	11	235-590-27	330	8
235-560-28	28	13	235-561-41	88	13	235-570-47	151	11	235-571-46	211	10	235-581-44	271	11	235-590-28	331	8
235-560-29	29	13	235-561-42	89	13	235-570-48	152	11	235-571-47	212	10	235-581-45	272	11	235-590-29	332	8
235-560-30	30	13	235-561-43	90	13	235-570-49	153	11	235-571-48	213	10	235-581-46	273	11	235-590-30	333	8
235-560-31	31	13	235-561-44	91	13	235-570-50	154	11	235-571-49	214	10	235-581-47	274	11	235-590-31	334	8
235-560-32	32	13	235-561-45	92	13	235-570-51	155	11	235-571-50	215	10	235-581-48	275	11	235-590-32	335	8
235-560-33	33	13	235-561-46	93	13	235-570-52	156	11	235-571-51	216	10	235-581-49	276	11	235-590-33	336	8
235-560-34	34	13	235-561-47	94	13	235-570-53	157	11	235-571-52	217	10	235-581-50	277	11	235-590-34	337	8
235-560-35	35	13	235-561-48	95	13	235-570-54	158	11	235-571-53	218	10	235-581-51	278	11	235-590-35	338	8
235-560-36	36	13	235-561-49	96	13	235-570-55	159	11	235-571-54	219	10	235-581-52	279	11	235-590-36	339	8
235-560-37	37	13	235-561-50	97	13	235-570-56	160	11	235-571-55	220	10	235-581-53	280	11	235-590-37	340	8
235-560-38	38	13	235-561-51	98	13	235-570-57	161	11	235-571-56	221	10	235-581-54	281	11	235-590-38	341	8
235-560-39	39	13	235-561-52	99	13	235-570-58	162	11	235-571-57	222	10	235-581-55	282	11	235-590-39	342	8
235-560-40	40	13	235-561-53	100	13	235-570-59	163	11	235-571-58	223	10	235-581-56	283	11	235-590-40	343	8
235-560-41	41	13	235-561-54	101	13	235-570-60	164	11	235-571-59	224	10	235-581-57	284	11	235-590-41	344	6
235-560-42	42	13	235-570-02	102	13	235-571-01	165	11	235-580-37	225	10	235-582-36	286	11	235-590-42	345	8
235-560-43	43	13	235-570-03	103	13	235-571-02	166	11	235-580-38	226	10	235-582-37	287	11	235-590-43	346	8
235-560-44	44	13	235-570-04	104	13	235-571-03	167	11	235-580-39	227	10	235-582-38	288	11	235-590-44	347	8
235-560-45	45	13	235-570-05	105	13	235-571-04	168	11	235-581-01	228	10	235-582-39	289	11	235-590-45	348	8
235-560-46	46	13	235-570-06	106	13	235-571-05	169	11	235-581-02	229	10	235-582-40	290	11	235-590-46	349	8
235-560-47	47	13	235-570-07	107	13	235-571-06	170	11	235-581-03	230	10	235-582-41	291	11	235-590-47	350	8
235-561-01	48	13	235-570-08	108	13	235-571-07	171	11	235-581-04	231	10	235-582-42	292	11	235-590-48	351	8
235-561-02	49	13	235-570-09	109	13	235-571-08	172	11	235-581-05	232	10	235-582-43	293	11	235-590-49	352	8
235-561-03	50	13	235-570-10	110	13	235-571-09	173	11	235-581-06	233	10	235-582-44	294	11	235-590-50	353	8
235-561-04	51	13	235-570-11	111	13	235-571-10	174	11	235-581-07	234	10	235-582-45	295	11	235-590-51	354	8
235-561-05	52	13	235-570-12	112	13	235-571-11	175	11	235-581-08	235	10	235-582-46	296	11	235-590-52	355	8
235-561-06	53	13	235-570-13	113	13	235-571-12	176	11	235-581-09	236	10	235-582-47	297	11	235-590-53	356	8
235-561-07	54	13	235-570-14	114	13	235-571-13	177	11	235-581-10	237	10	235-582-48	298	11	235-590-54	357	8
235-561-08	55	13	235-570-15	115	13	235-571-14	178	11	235-581-11	238	10	235-582-49	299	11	235-590-55	358	8
235-561-09	56	13	235-570-16	116	13	235-571-15	179	11	235-581-12	239	10	235-582-50	300	11	235-590-56	359	8
235-561-10	57	13	235-570-17	117	13	235-571-16	180	11	235-581-13	240	10	235-582-51	301	11	235-590-57	360	8
235-561-11	58	13	235-571-18	118	13	235-571-17	181	11	235-581-14	241	10	235-582-52	302	11	235-590-58	361	8
235-561-12	59	13	235-571-19	119	13	235-571-18	182	11	235-581-15	242	10	235-590-01	303	8	235-591-15	362	8
235-561-13	60	13	235-571-20	120	13	235-571-19	183	11	235-581-16	243	10	235-590-02	304	8	235-591-16	363	8



PROPOSED BOUNDARIES OF HARMONY GROVE SEWER SERVICE AREA

COUNTY OF SAN DIEGO
STATE OF CALIFORNIA

ASSESSORS PARCEL NUMBER	MAP REFERENCE NUMBER	SHEET NUMBER	ASSESSORS PARCEL NUMBER	MAP REFERENCE NUMBER	SHEET NUMBER	ASSESSORS PARCEL NUMBER	MAP REFERENCE NUMBER	SHEET NUMBER	ASSESSORS PARCEL NUMBER	MAP REFERENCE NUMBER	SHEET NUMBER	ASSESSORS PARCEL NUMBER	MAP REFERENCE NUMBER	SHEET NUMBER	ASSESSORS PARCEL NUMBER	MAP REFERENCE NUMBER	SHEET NUMBER
235-601-07	424	7	235-610-15	544	9	235-620-11	601	2	235-630-06	661	3	235-640-21	721	5	235-650-07	781	4
235-601-08	425	7	235-610-16	545	9	235-620-12	602	2	235-630-07	662	3	235-640-22	722	5	235-650-08	782	4
235-601-09	426	7	235-610-17	546	9	235-620-13	603	2	235-630-08	663	3	235-640-23	723	5	235-650-09	783	4
235-601-10	427	7	235-610-18	547	9	235-620-14	604	2	235-630-09	664	3	235-640-24	724	5	235-650-10	784	4
235-601-11	428	7	235-610-19	548	9	235-620-15	605	2	235-630-10	665	3	235-640-25	725	5	235-650-11	785	4
235-601-12	429	7	235-610-20	549	9	235-620-16	606	2	235-630-11	666	3	235-640-26	726	5	235-650-12	786	4
235-601-13	430	7	235-610-21	550	9	235-620-17	607	2	235-630-12	667	3	235-640-27	727	6	235-650-13	787	4
235-601-14	431	7	235-610-22	551	9	235-620-18	608	2	235-630-13	668	3	235-640-28	728	6	235-650-14	788	4
235-601-15	432	7	235-610-23	552	9	235-620-19	609	2	235-630-14	669	3	235-640-29	729	6	235-650-15	789	4
235-601-16	433	7	235-610-24	553	9	235-620-20	610	2	235-630-15	670	3	235-640-30	730	6	235-650-16	790	4
235-601-17	434	7	235-610-25	554	9	235-620-21	611	2	235-630-16	671	3	235-640-31	731	6	235-650-17	791	4
235-601-18	435	7	235-610-26	555	9	235-620-22	612	2	235-630-17	672	3	235-640-32	732	6	235-650-18	792	4
235-601-19	436	7	235-610-27	556	10	235-620-23	613	2	235-630-18	673	3	235-640-33	733	6	235-650-19	793	4
235-601-20	437	7	235-610-28	557	10	235-620-24	614	2	235-630-19	674	3	235-640-34	734	6	235-650-20	794	4
235-601-21	438	7	235-610-29	558	10	235-620-25	615	2	235-630-20	675	3	235-640-35	735	6	235-650-21	795	4
235-601-22	439	7	235-610-30	559	10	235-620-26	616	2	235-630-21	676	3	235-640-36	736	6	235-650-22	796	4
235-601-23	440	7	235-610-31	560	10	235-620-27	617	2	235-630-22	677	3	235-640-37	737	6	235-650-23	797	4
235-601-24	441	7	235-610-32	561	10	235-620-28	618	2	235-630-23	678	3	235-640-38	738	6	235-650-24	798	4
235-601-25	442	7	235-610-33	562	10	235-620-29	619	2	235-630-24	679	3	235-640-39	739	6	235-650-25	799	4
235-601-26	443	7	235-610-34	563	10	235-620-30	620	2	235-630-25	680	3	235-640-40	740	6	235-650-26	800	4
235-601-27	444	7	235-610-35	564	9	235-620-31	621	2	235-630-26	681	3	235-640-41	741	6	235-650-27	801	4
235-601-28	445	7	235-610-36	565	9	235-620-32	622	2	235-630-27	682	3	235-640-42	742	6	235-650-28	802	4
235-601-29	446	7	235-610-37	566	9	235-620-33	623	2	235-630-28	683	3	235-640-43	743	6	235-650-29	803	4
235-601-30	447	7	235-610-38	567	9	235-620-34	624	2	235-630-29	684	3	235-640-44	744	6	235-650-30	804	4
235-601-31	448	7	235-610-39	568	9	235-620-35	625	2	235-630-30	685	3	235-640-45	745	6	235-650-31	805	4
235-601-32	449	7	235-610-40	569	9	235-620-36	626	2	235-630-31	686	3	235-640-46	746	6	235-650-32	806	4
235-601-33	450	7	235-610-41	570	9	235-620-37	627	2	235-630-32	687	3	235-640-47	747	6	235-650-33	807	4
235-601-34	451	7	235-610-42	571	9	235-620-38	628	2	235-630-33	688	3	235-640-48	748	6	235-650-34	808	4
235-601-35	452	7	235-610-43	572	9	235-620-39	629	2	235-630-34	689	3	235-640-49	749	6	235-650-35	809	4
235-601-36	453	7	235-610-44	573	9	235-620-40	630	2	235-630-35	690	3	235-640-50	750	6	235-650-36	810	12
235-601-37	454	7	235-610-45	574	9	235-620-41	631	2	235-630-36	691	3	235-640-51	751	6	235-650-37	811	12
235-601-38	455	7	235-610-46	575	9	235-620-42	632	2	235-630-37	692	3	235-640-52	752	6	235-650-38	812	12
235-601-39	456	7	235-610-47	576	9	235-620-43	633	2	235-630-38	693	3	235-640-53	753	6	235-650-39	813	12
235-601-40	457	7	235-610-48	577	9	235-620-44	634	2	235-630-39	694	3						
235-601-41	458	7	235-610-49	578	9	235-620-45	635	2	235-630-40	695	3						
235-601-42	459	7	235-610-50	579	9	235-620-46	636	2	235-630-41	696	3						
235-601-43	460	7	235-610-51	580	9	235-620-47	637	2	235-630-42	697	3						
235-601-44	461	7	235-610-52	581	9	235-620-48	638	2	235-630-43	698	3						
235-601-45	462	7	235-610-53	582	9	235-620-49	639	2	235-630-44	699	3						
235-601-46	463	7	235-610-54	583	9	235-620-50	640	2	235-630-45	700	3						
235-601-47	464	7	235-610-55	584	9	235-620-51	641	2	235-630-46	701	3						
235-601-48	465	7	235-610-56	585	9	235-620-52	642	2	235-630-47	702	3						
235-601-49	466	7	235-610-57	586	9	235-620-53	643	2	235-630-48	703	3						
235-601-50	467	7	235-610-58	587	9	235-620-54	644	2	235-630-49	704	3						
235-601-51	468	7	235-610-59	588	9	235-620-55	645	2	235-630-50	705	3						
235-601-52	469	7	235-610-60	589	9	235-620-56	646	2	235-630-51	706	3						
235-601-53	470	8	235-610-61	590	8	235-620-57	647	2	235-630-52	707	3						
235-601-54	471	8	235-610-62	591	8	235-620-58	648	2	235-630-53	708	3						
235-601-55	472	8	235-610-63	592	8	235-620-59	649	2	235-630-54	709	3						
235-601-56	473	8	235-610-64	593	8	235-620-60	650	2	235-630-55	710	3						
235-601-57	474	8	235-610-65	594	8	235-620-61	651	2	235-630-56	711	3						
235-601-58	475	8	235-610-66	595	8	235-620-62	652	2	235-630-57	712	3						
235-601-59	476	8	235-610-67	596	8	235-620-63	653	2	235-630-58	713	3						
235-601-60	477	8	235-610-68	597	8	235-620-64	654	2	235-630-59	714	3						
235-601-61	478	8	235-610-69	598	8	235-620-65	655	2	235-630-60	715	3						
235-601-62	479	9	235-610-70	599	2	235-620-66	656	2	235-630-61	716	3						
235-601-63	480	9	235-610-71	600	2	235-620-67	657	2	235-630-62	717	3						
235-601-64	481	9	235-610-72	601	2	235-620-68	658	2	235-630-63	718	3						
235-601-65	482	9	235-610-73	602	2	235-620-69	659	2	235-630-64	719	3						
235-601-66	483	9	235-610-74	603	2	235-620-70	660	2	235-630-65	720	3						